

3 1/2-ZIMMER-WOHNUNGEN



Wohnfläche 85,0 m²
Balkon/Loggia 12,6 m²

wie abgebildet
WHG Ca 1.1
WHG Ca 2.1

gespiegelter Grundriss
WHG Dc 1.3
WHG Dc 2.3

2. Obergeschoss

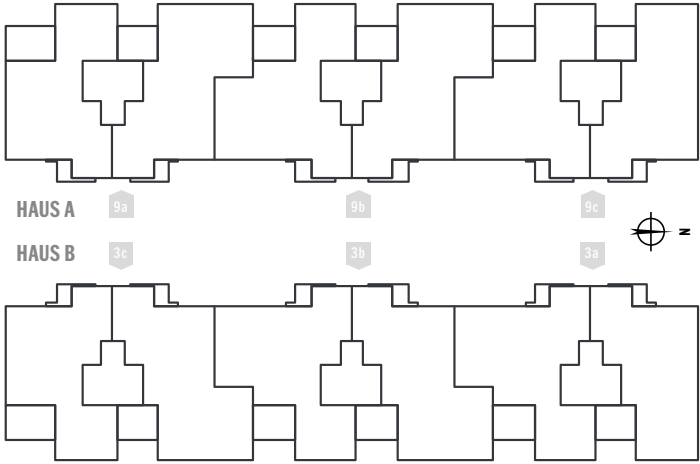
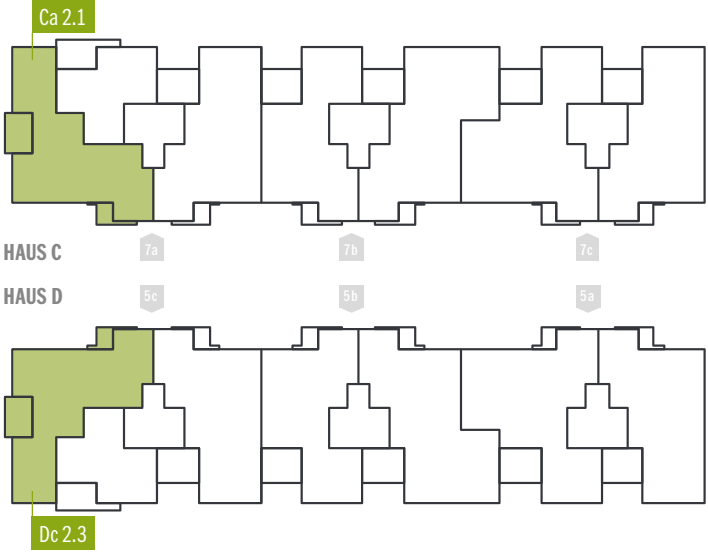

1. Obergeschoss

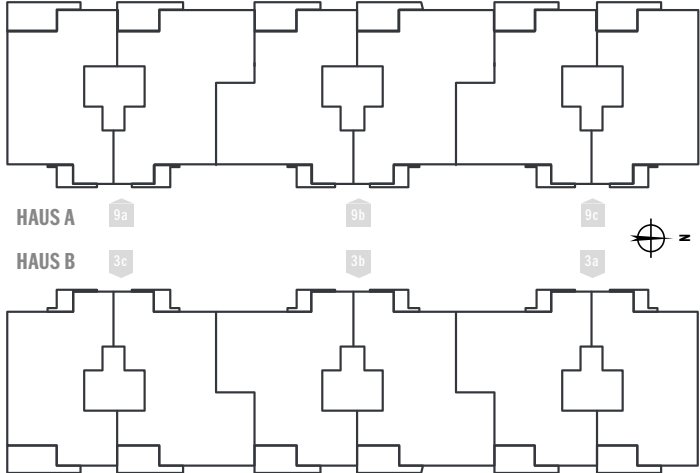
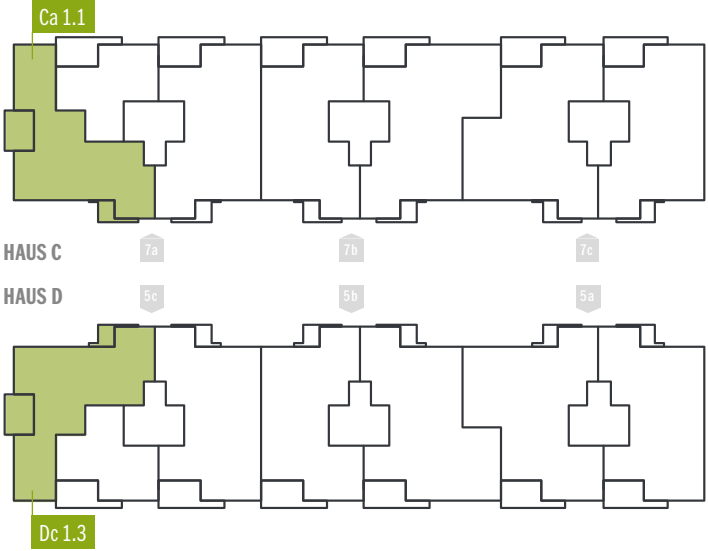

Erdgeschoss

